



Leaf

designer SUN YI

product DESK LAMP

update 2016/11/20

Guangdong University of Technology
Opendesign Workshop

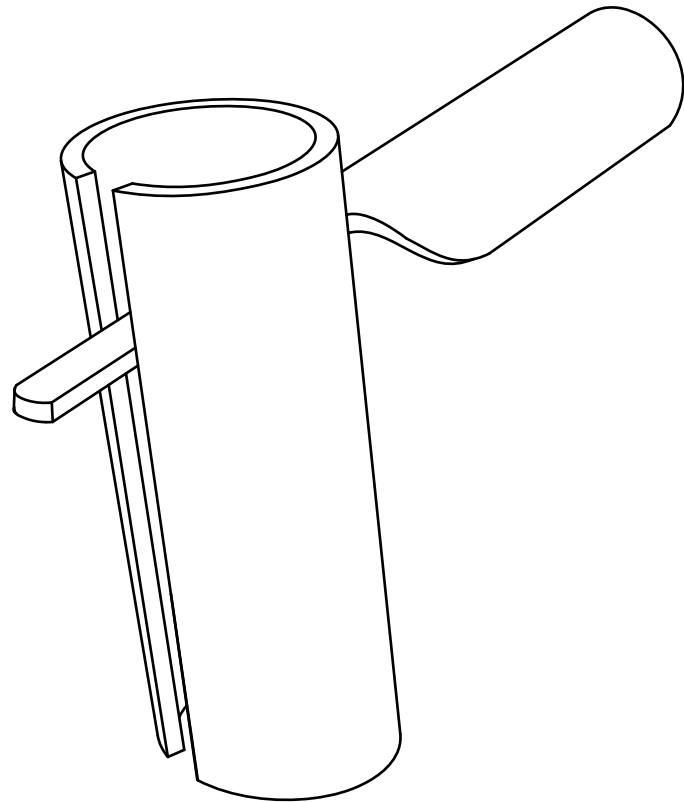

MATERIALS



Bamboo*2

1Φ80~90mm*300mm
2Φ65~70mm*410mm



LED Strip

10mm*1piece
12V , hard

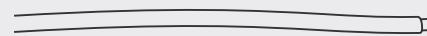

Wire

Plastic-covered
Φ1.5*6000mm

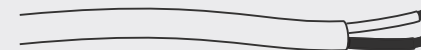

Cable

>5000mm 2A
transparent

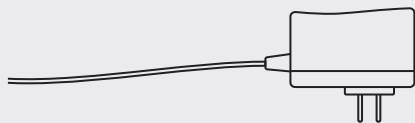

Transformer

from 220V to 12V



rubber band

or bungie

TOOLS



Saw



Ax

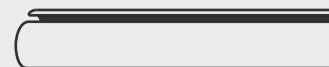

Sandpaper

180/320/500



Electrodrill

Φ20mm

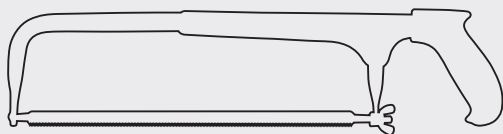

Saw

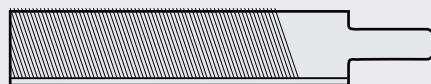

File

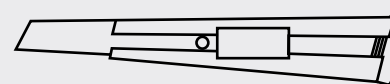

Knife



MANUFACTURING

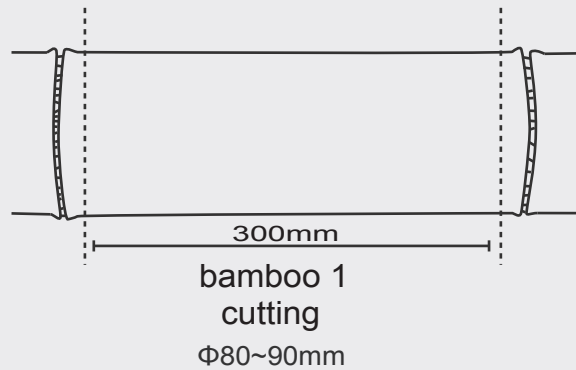

Cut a bevel
sand the corners



Make a hole $\Phi 20\text{mm}$
sand the corners



Cut a seam
make them smooth

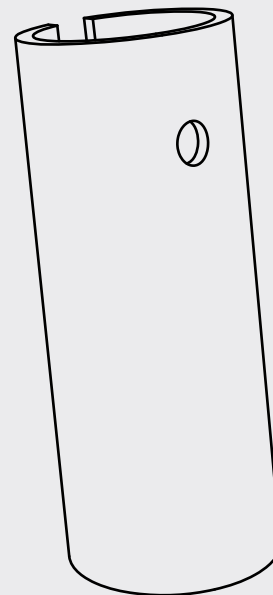

PerspectiveFront

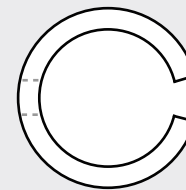

Top

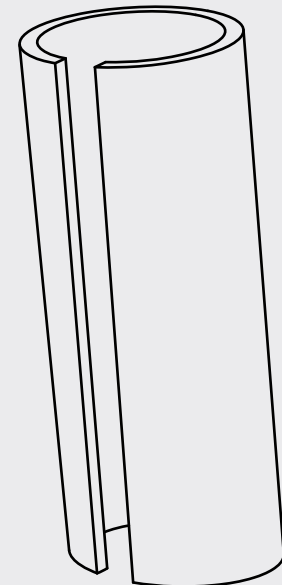

Perspective Back



MANUFACTURING

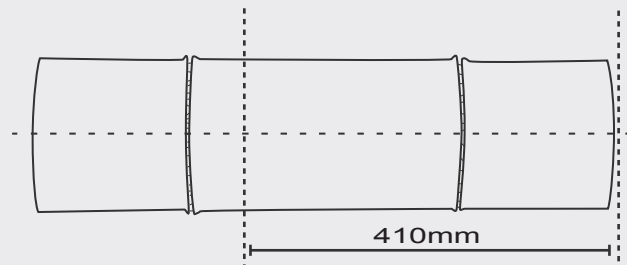

bamboo 2
cutting
Φ65~70mm



cutting and 2/5 bamboo

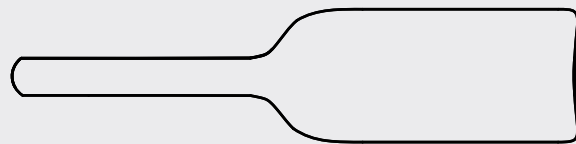

sand the corners,
make them smooth

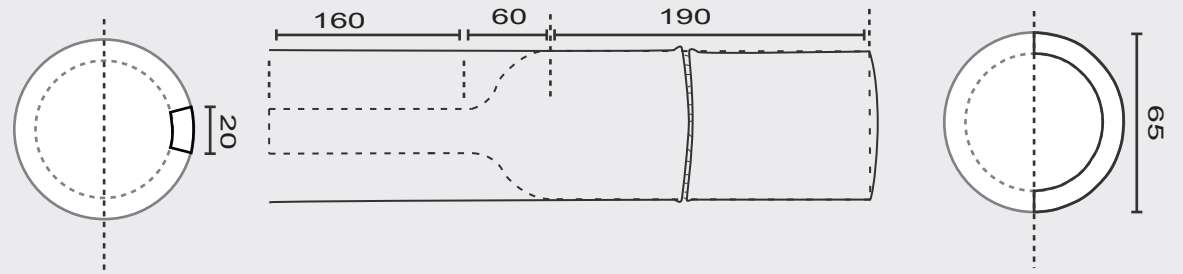
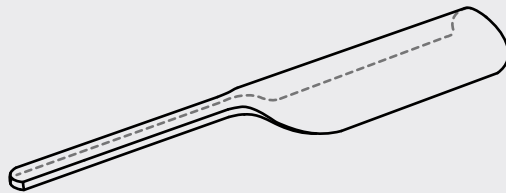

ASSEMBLY

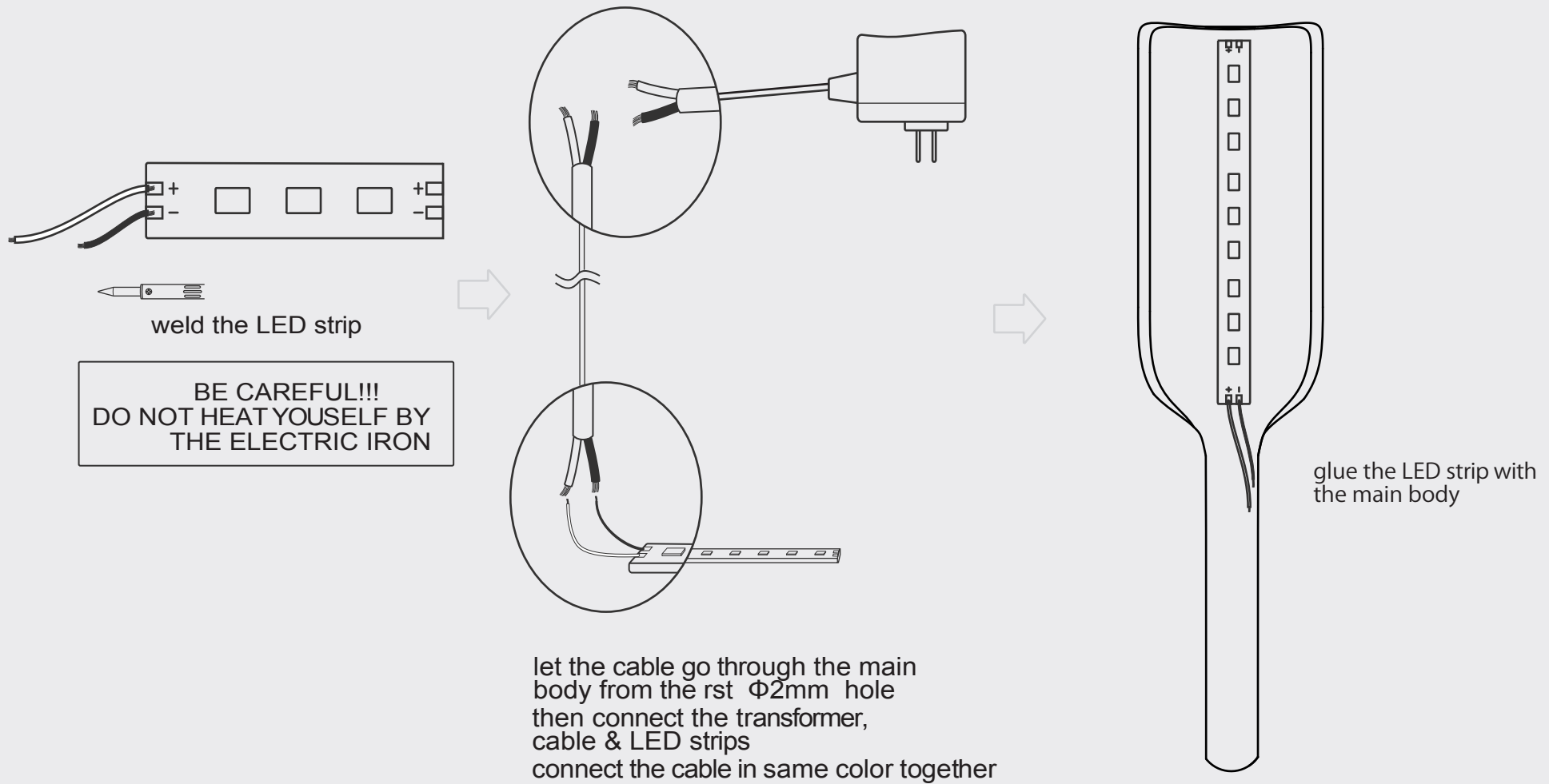

ASSEMBLY

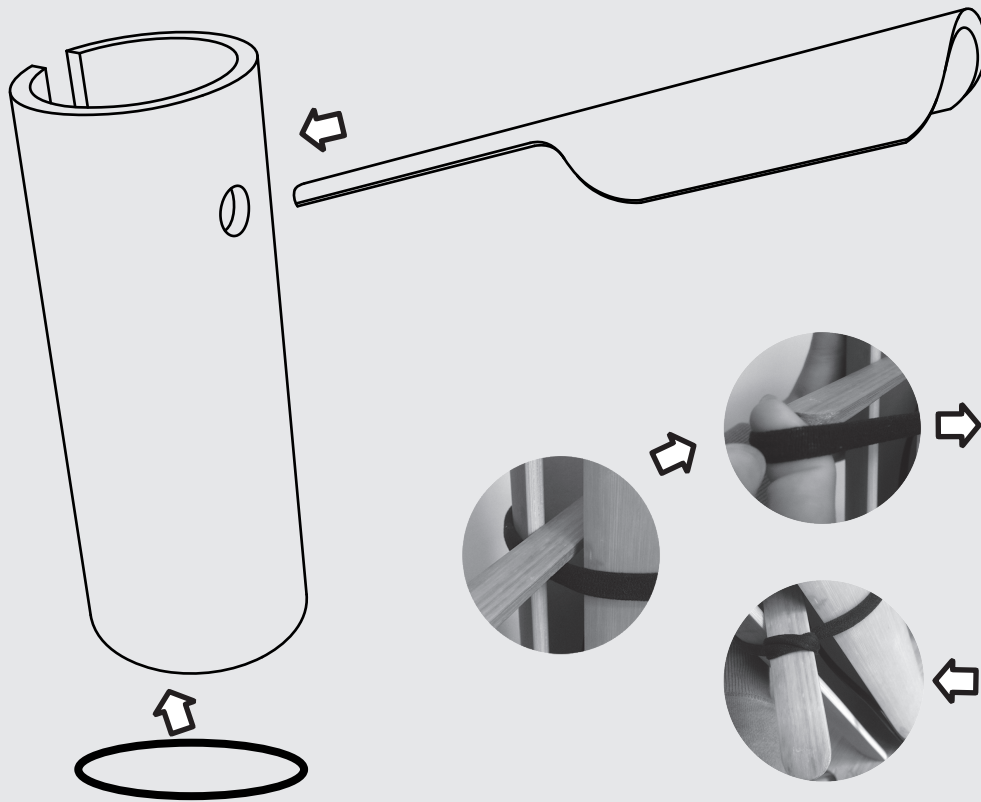

In the bamboo a rubber band
used to move the position of the desk lamp

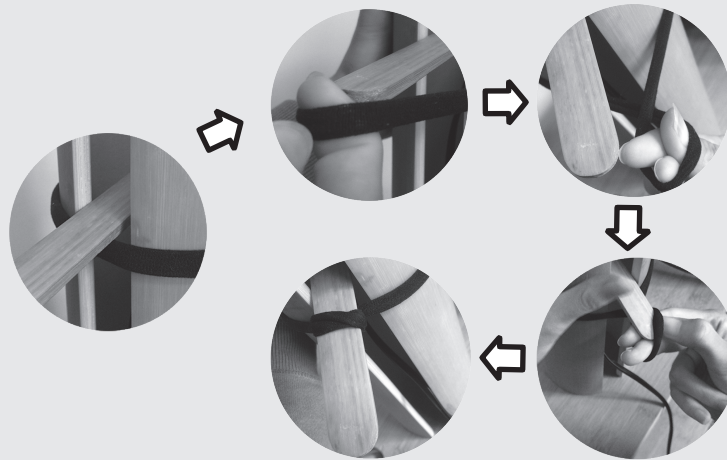

the rubber bands connect

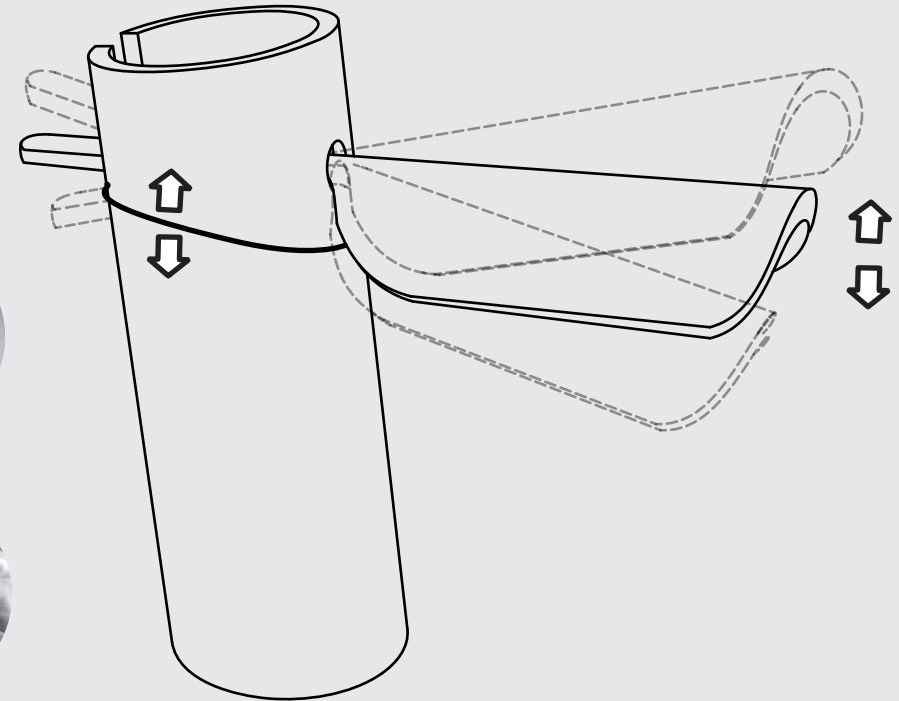

By pulling the rubber up or down
you will adjust the position of the lamp

