



BOO-X

Designer CHEN CHANGBIAO

Product READING CHAIR

Materials Ply-bamboo(1500mmx500mmx10mm)
Bamboo(Φ 25x440mm/ Φ 25x800mm/ Φ 25x950mm)
Steel nail(Φ 4x35mm)

Tools Saw,Electric drill,Sandpaper

update 2017/06/04

Guangdong University of Technology
Opendedesign Workshop

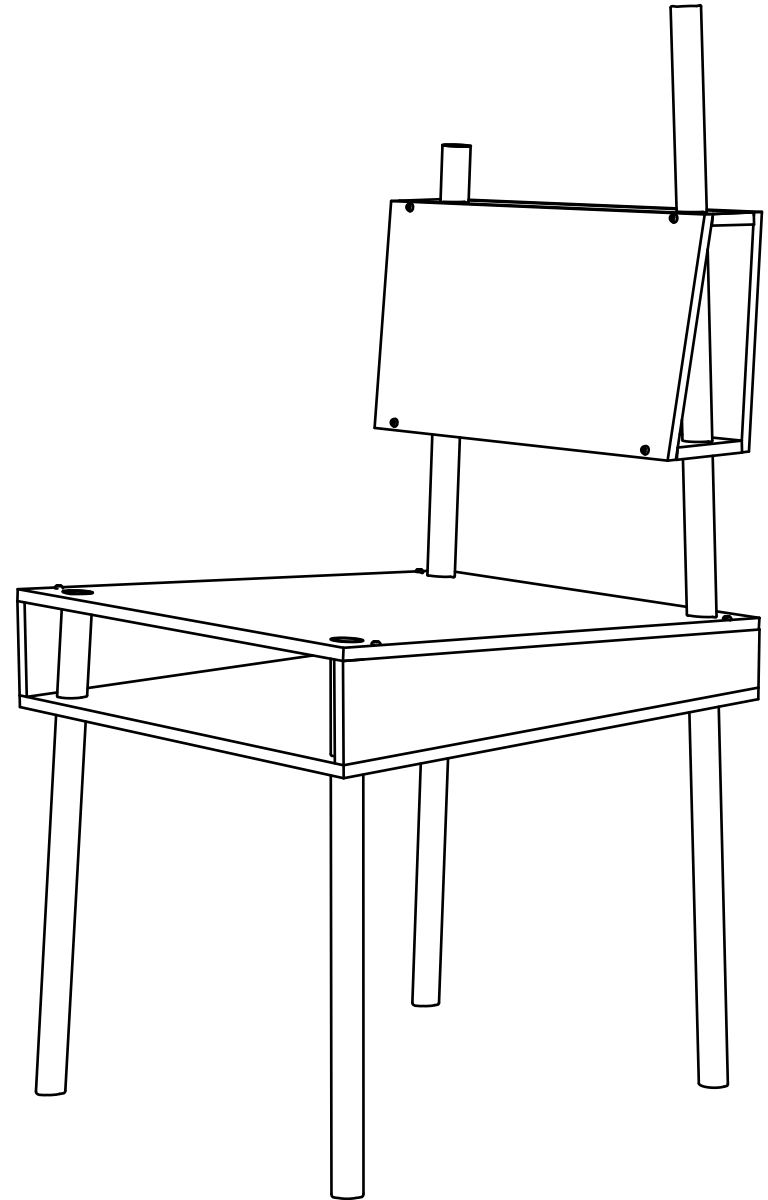

PARTS

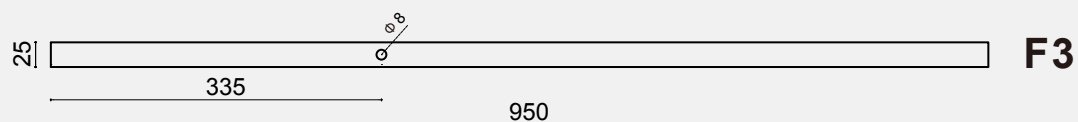
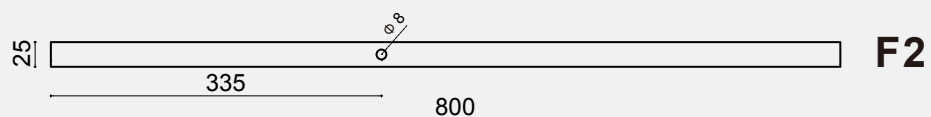
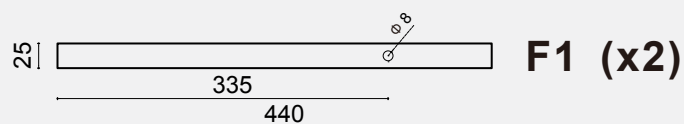
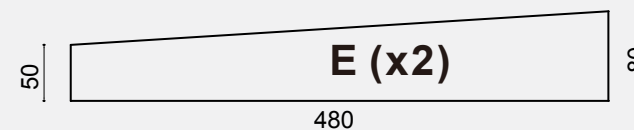
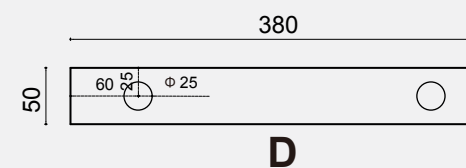
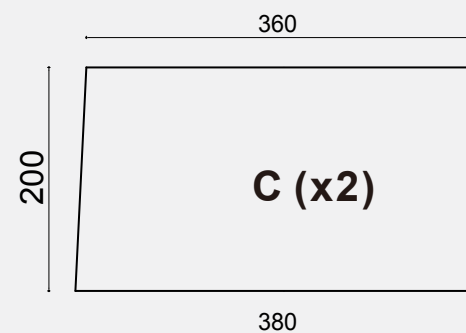
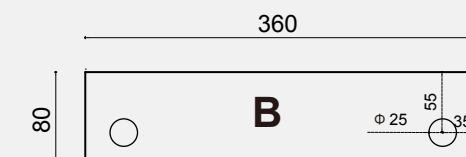
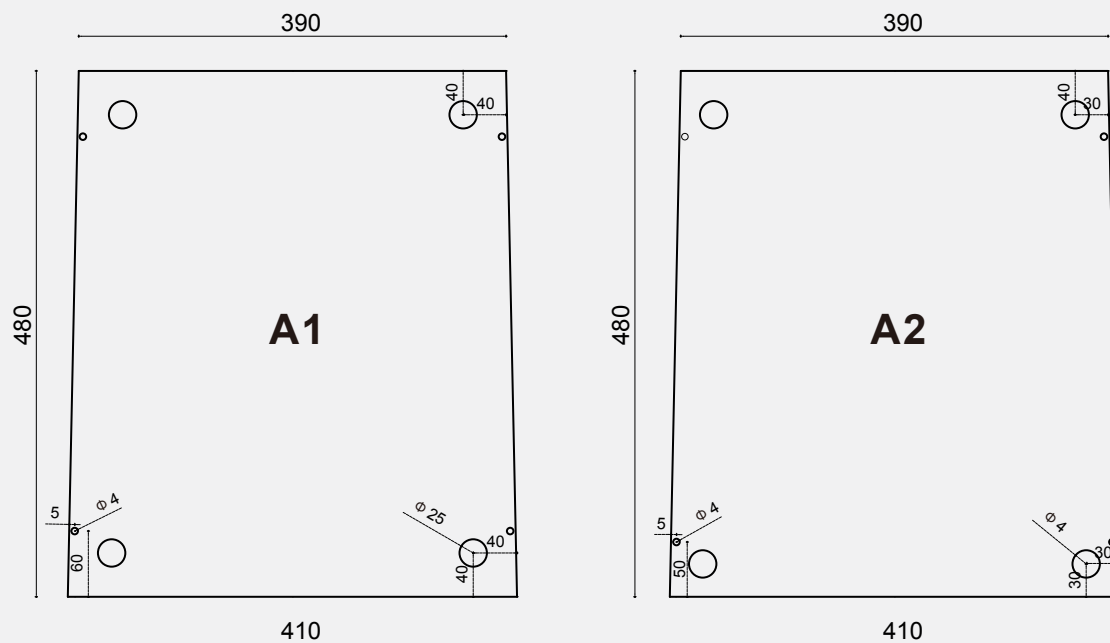

ASSEMBLY

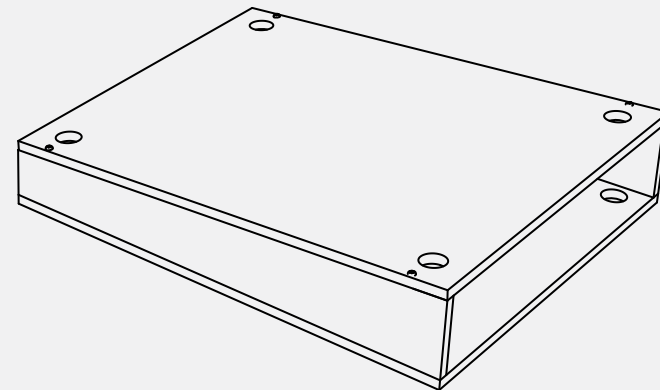
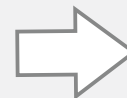
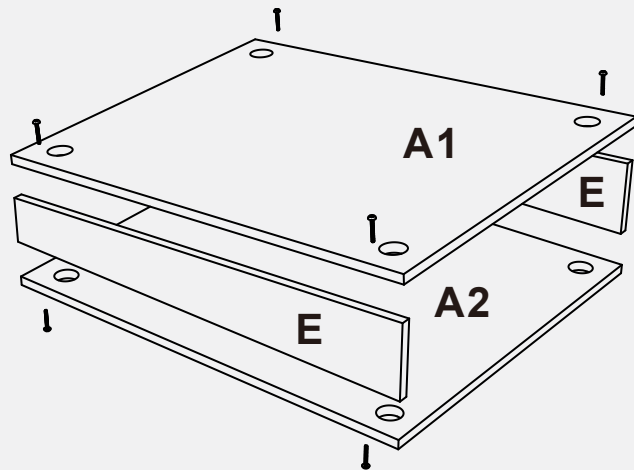
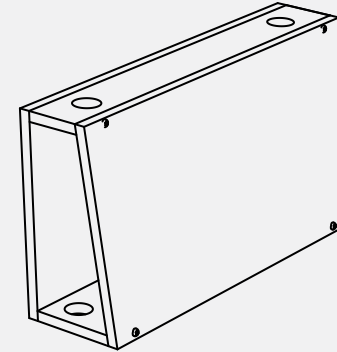
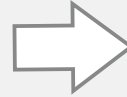
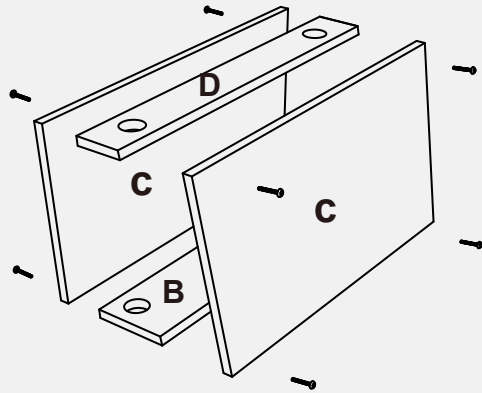

ASSEMBLY

