



F-TEA

designer Li Cuiyan
product Tea table

Materials Ply-bamboo (1953*615*15 mm*1piece)
Bamboo (Φ 15 mm / Φ 25-30 mm)

Tools Saw,Electrodrill (Φ 15 mm),

update 2017/06/06
Guangdong University of Technology
Opendesign Workshop

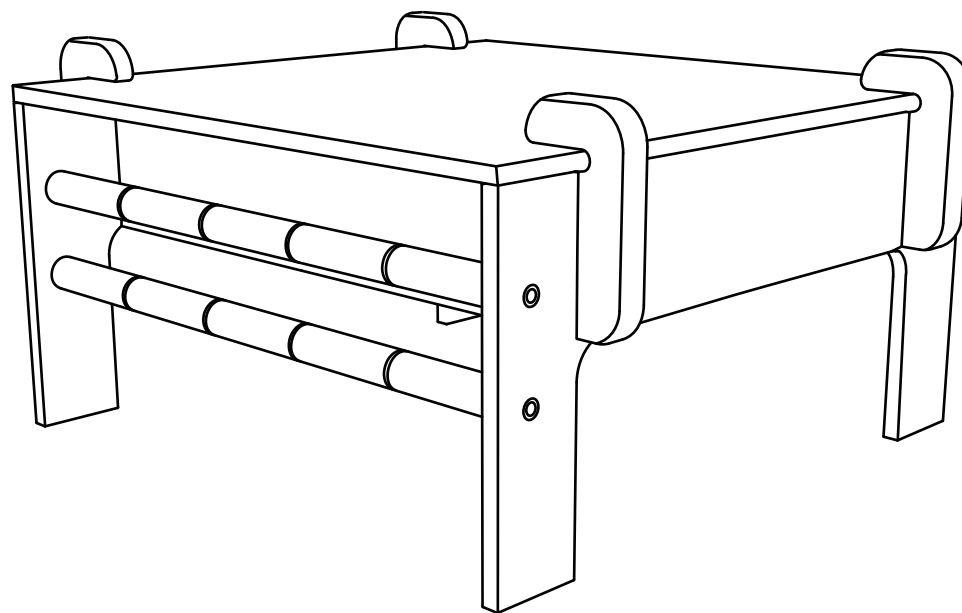

PARTS MEASUREMENTS:(mm)

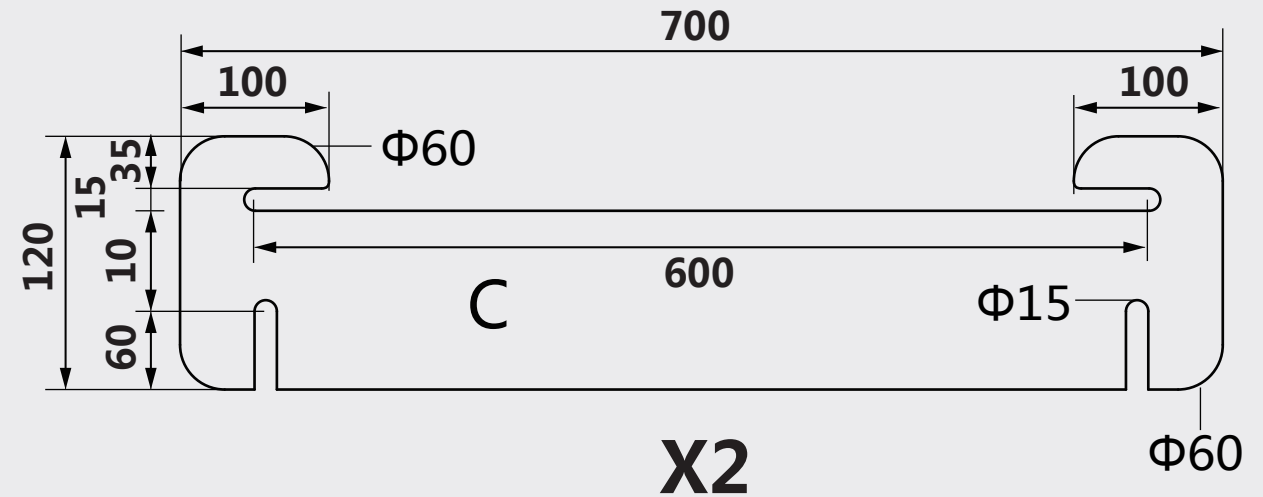
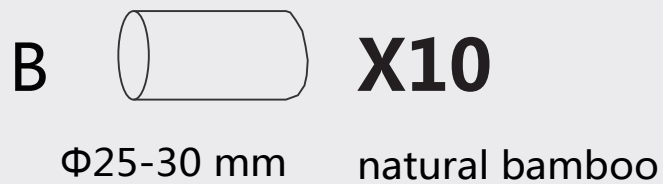
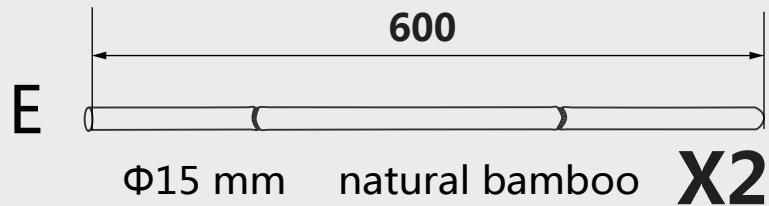
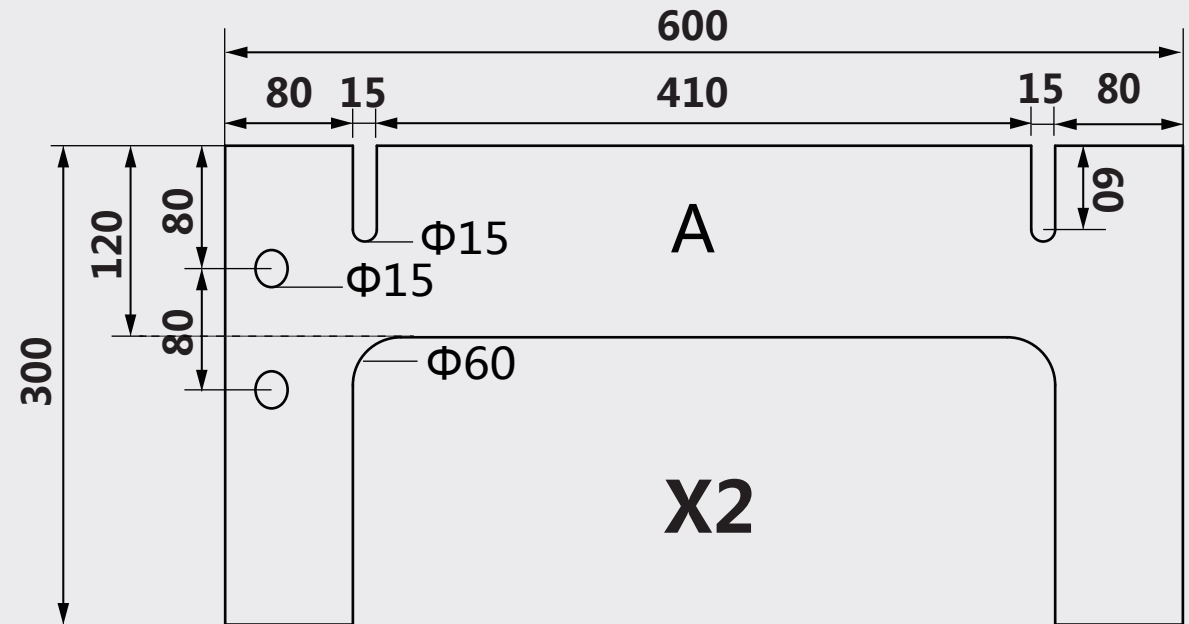
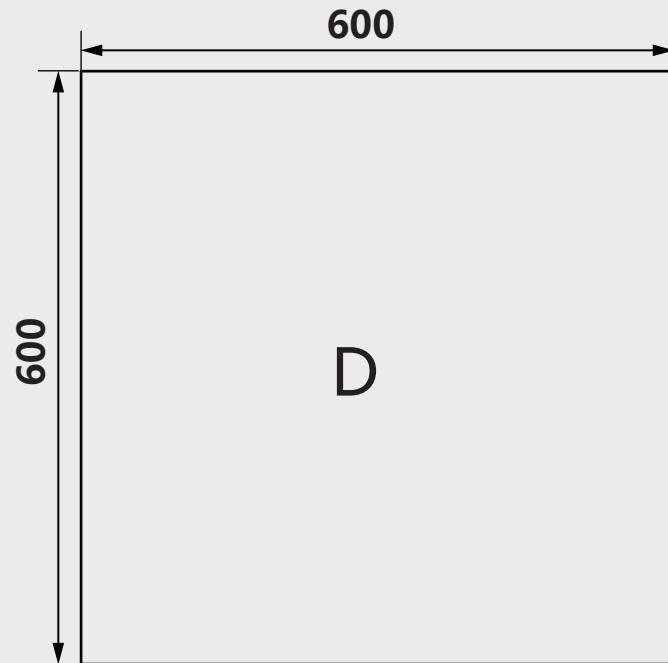

ASSEMBLY INSTRUCTION 1:

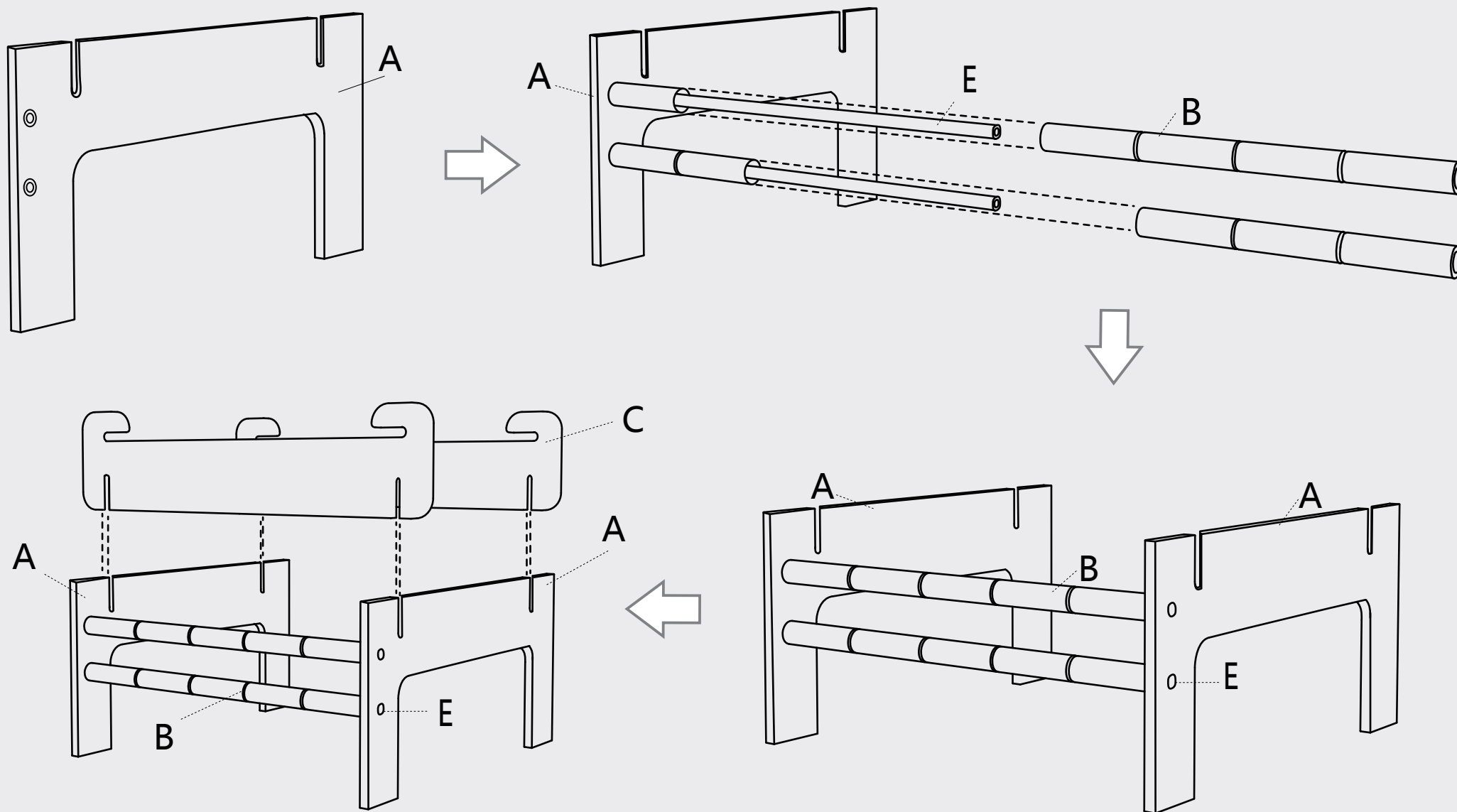

ASSEMBLY INSTRUCTION 2:

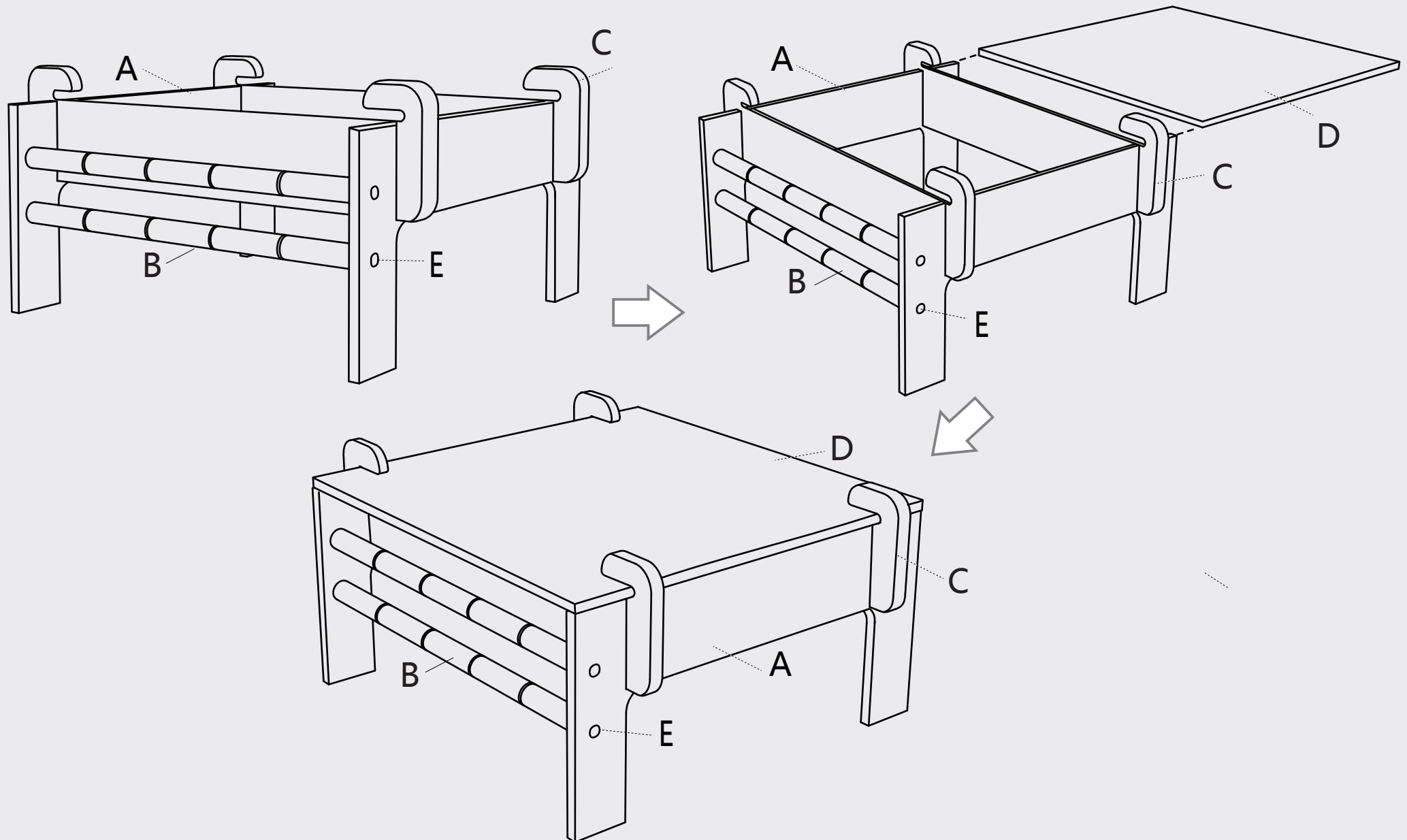

F-TEA

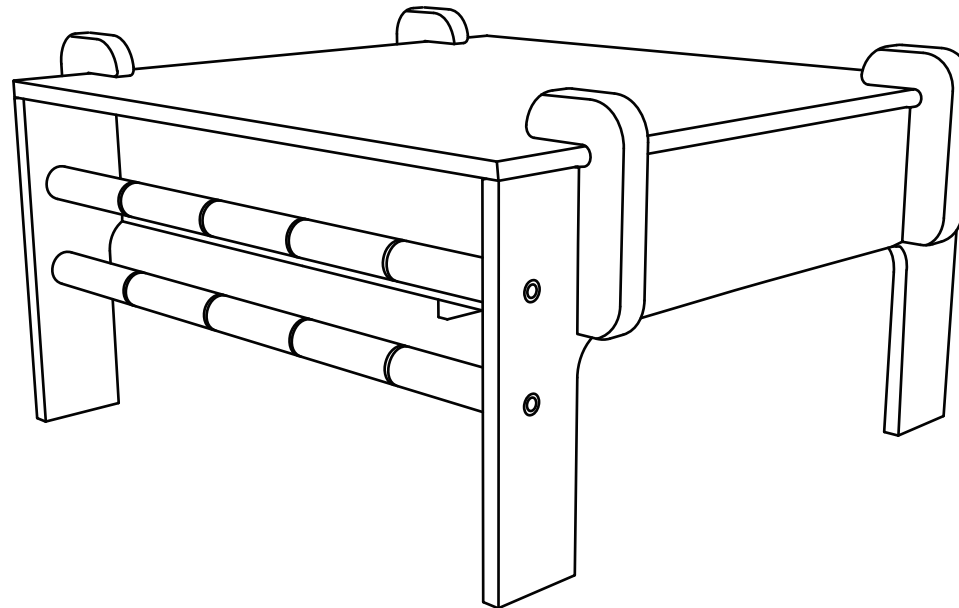

*IF YOU MEET SOME PROBLEMS WHEN BUILDING THIS F-TEA,PLEASE CONTACT US 842940440@qq.com.