

Sandwich 2.0

*This product is based on Skyline by Huang Shiya, Li Jiajie, Ma Jieying

designers Li Dongsheng, Xu Jiachun

product handbag, shoulder bag, drawstring backpack

materials Ply-bamboo
Denim fabric
Felt fabric
Cotton rope
Braided strap
Leather strap
Ledger screw
Round magnet
Eyelet ribets

tools Pencil, ruler, compass, scissors,
saw, file, sandpaper, screwdriver,
electrodrill($\Phi 4\text{mm}$), hole punch,
a ir-eye mounting tools

update 2017/12/01

Guangdong University of Technology
Opendedesign+DIY Workshop

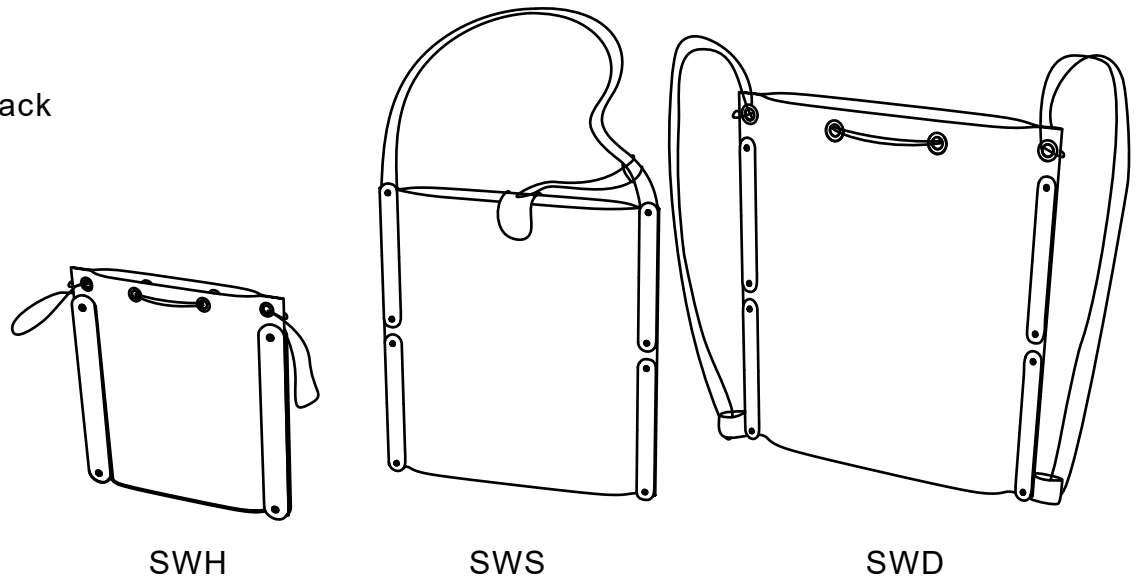

PARTS(mm)

Ply-bamboo

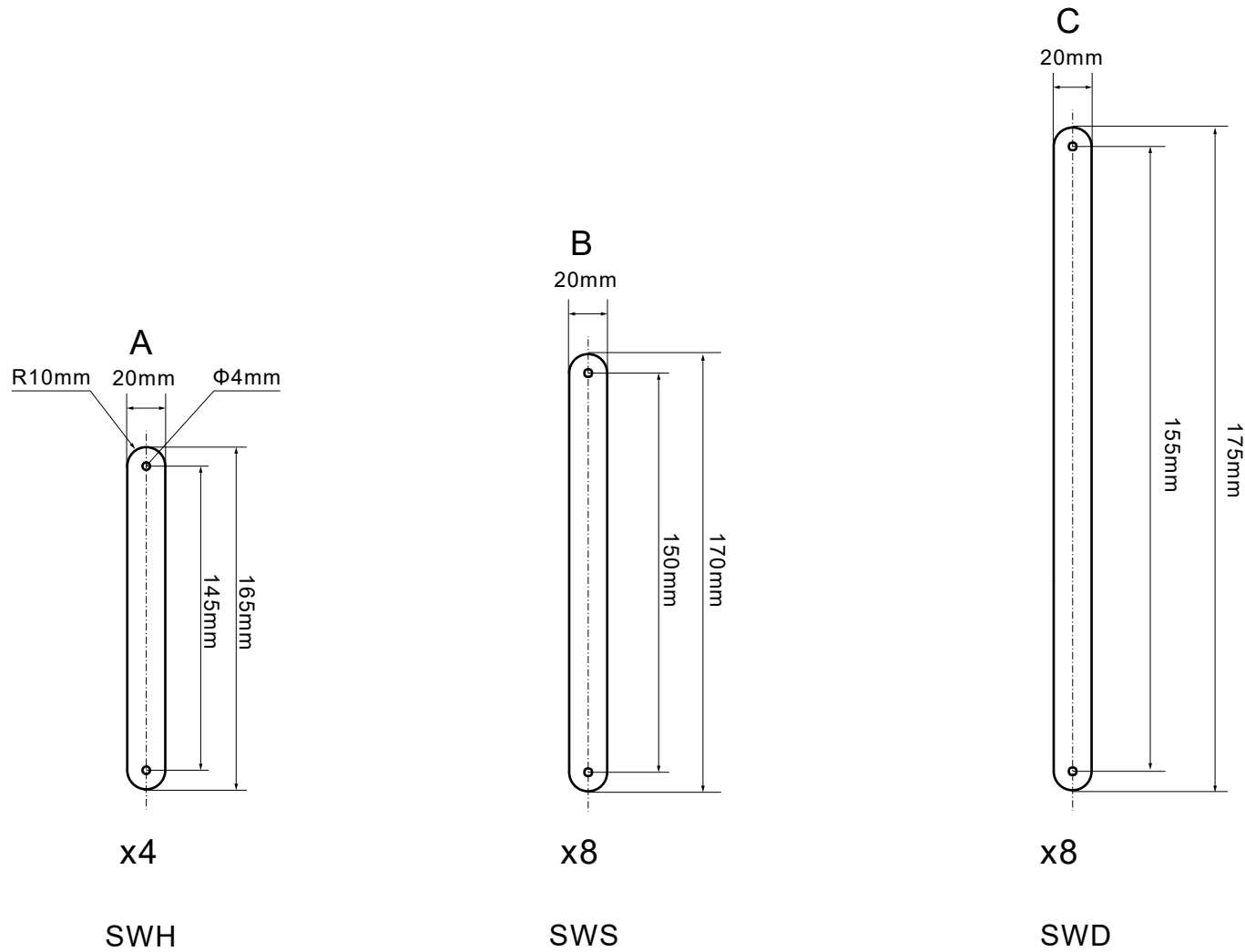

PARTS(mm)

Leather strap



D 500mm x1

Ledger screw

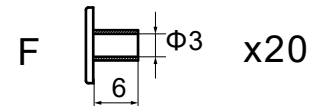
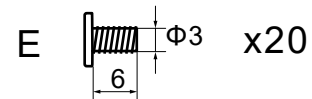

Cotton rope



G 500mm x2

H 2200mm x2

Eyelet ribets



I R 5mm x4

J R 10mm x4

Felt fabric

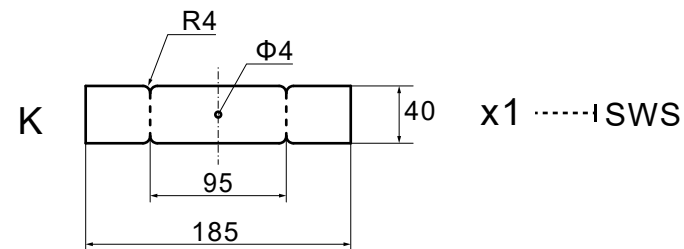

Braided strap



SWS

Round magnet

M Φ10mm*2mm x4 SWS

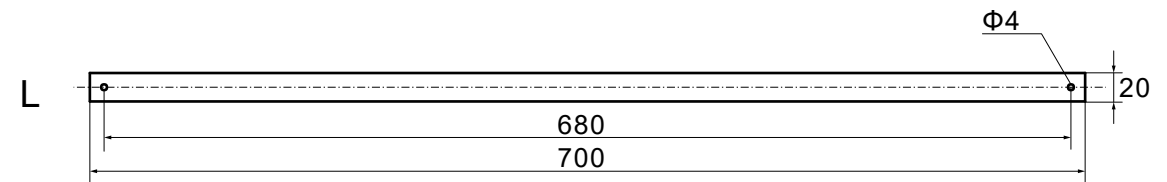

Parts (mm)

Denim fabric

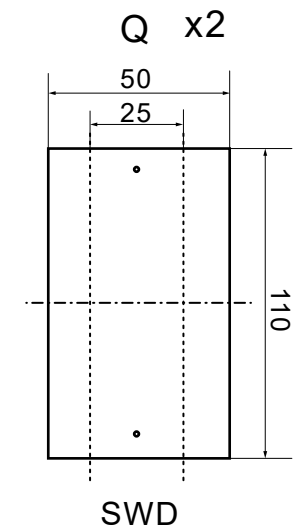
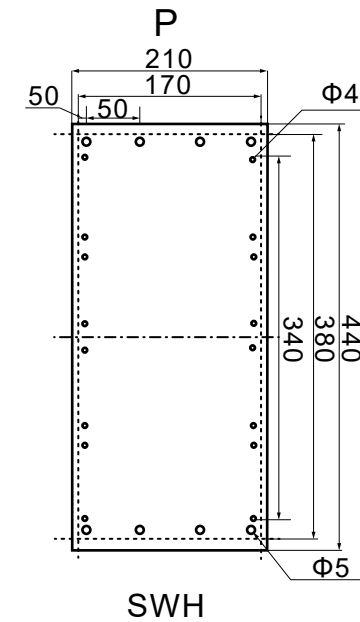
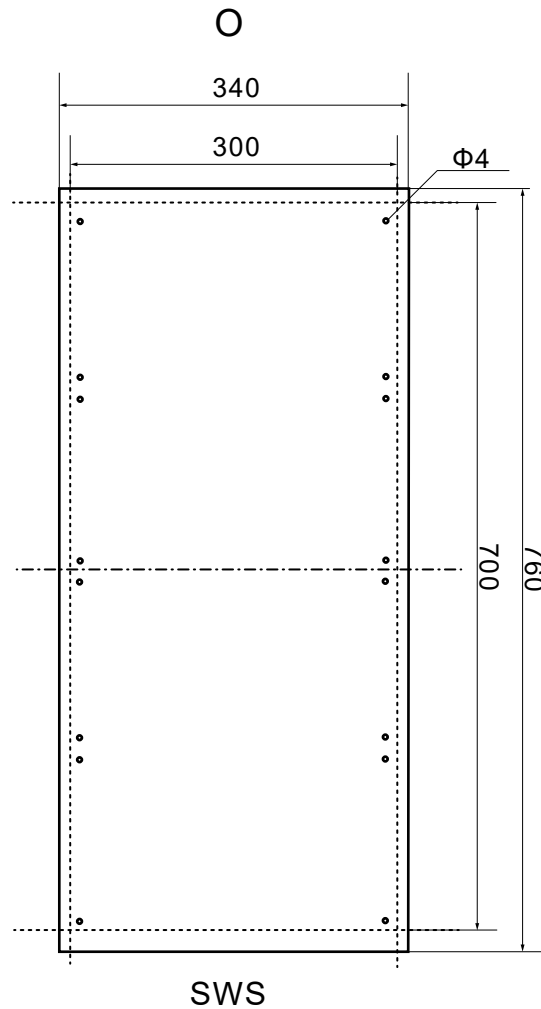
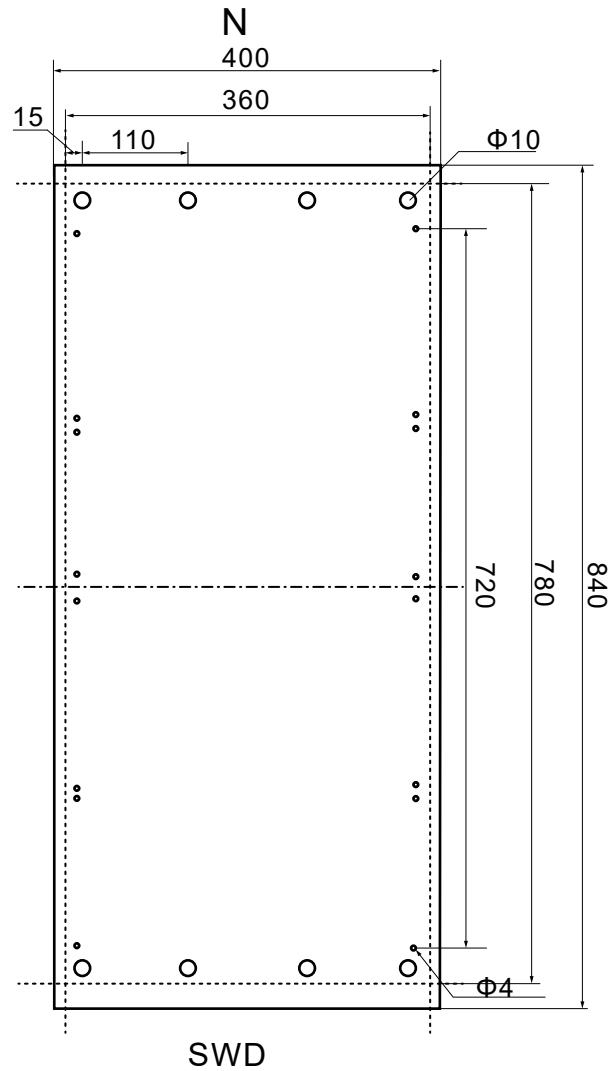

ASSEMBLY - Shoulder bag

① Fold the both parts of O .

② Assemble the elements below with a screwdriver .

③ Assemble the clip and link it with the shoulder bag.

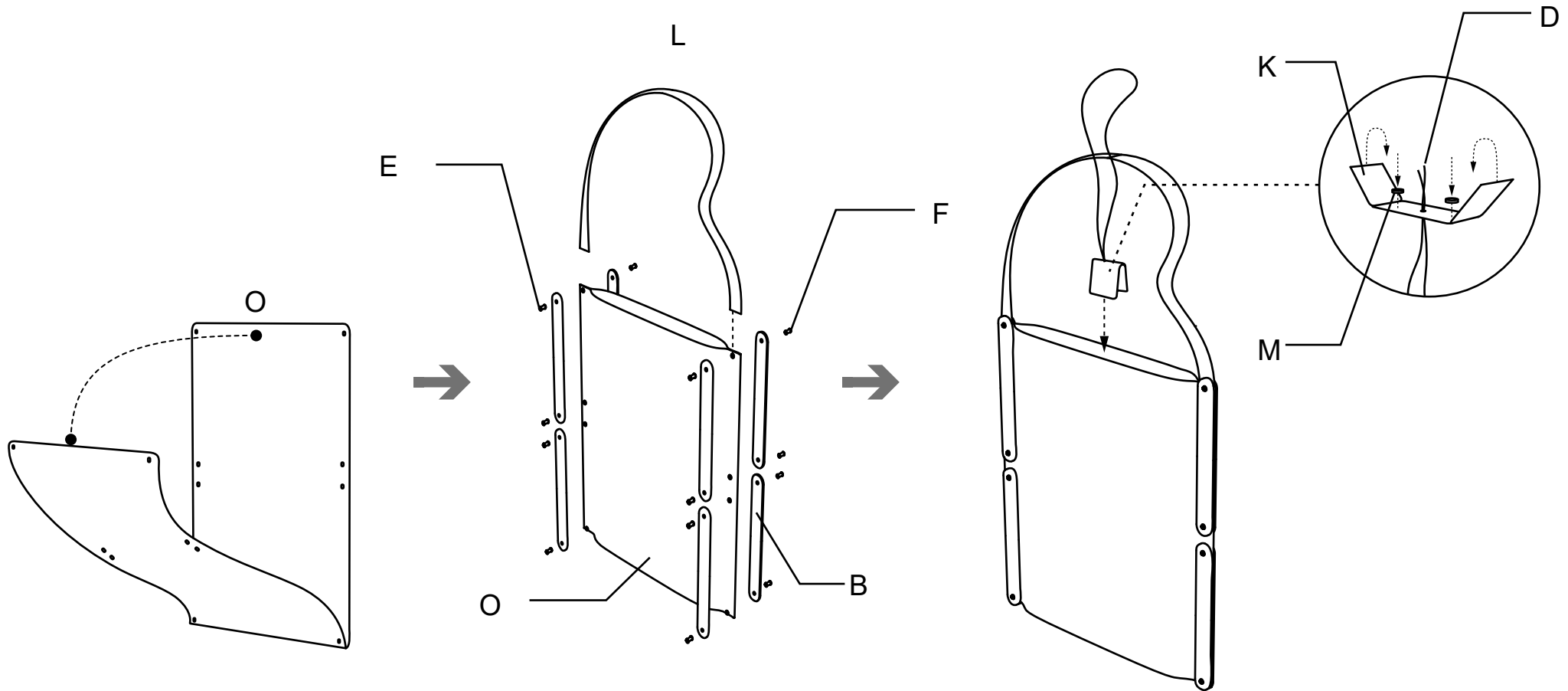

ASSEMBLY - Handbag

① Fold the both parts of P .

② Assemble the elements below with a screwdriver .

③ Assemble the clip and link it with the handbag.

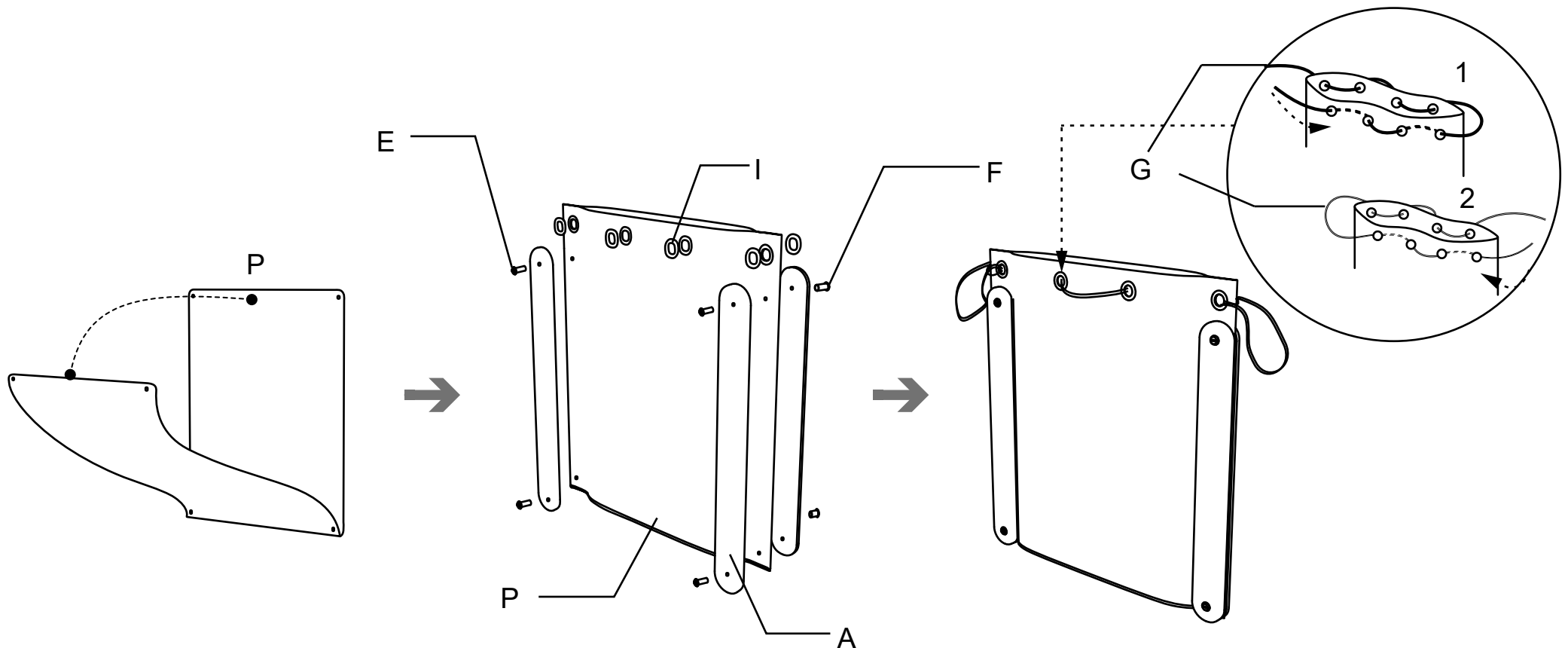

ASSEMBLY - Briefcase

① Fold the both parts of N.

② Assemble the elements below with a screwdriver .

③ Assemble the clip and link it with the drawstring backpack.

